

System Flammotect 2 × 50 mm

8.5.3 Design with fire protection collar EC Endless Collar

The fire protection collar must be attached on both sides in walls and on the lower side in floors. Always use the smallest fitting collar.

The collars must be fastened to the seal with the following coarse thread screws or coil spring fasteners:

- Würth ASSY D (8 × 70 mm)
- HECO-TOPIX-plus (8 × 80 mm)
- SPAX T-STAR plus (8 × 80 mm)
- Rockwool Conlit Screw
- Bohl Fireprotect Screw or equivalent.

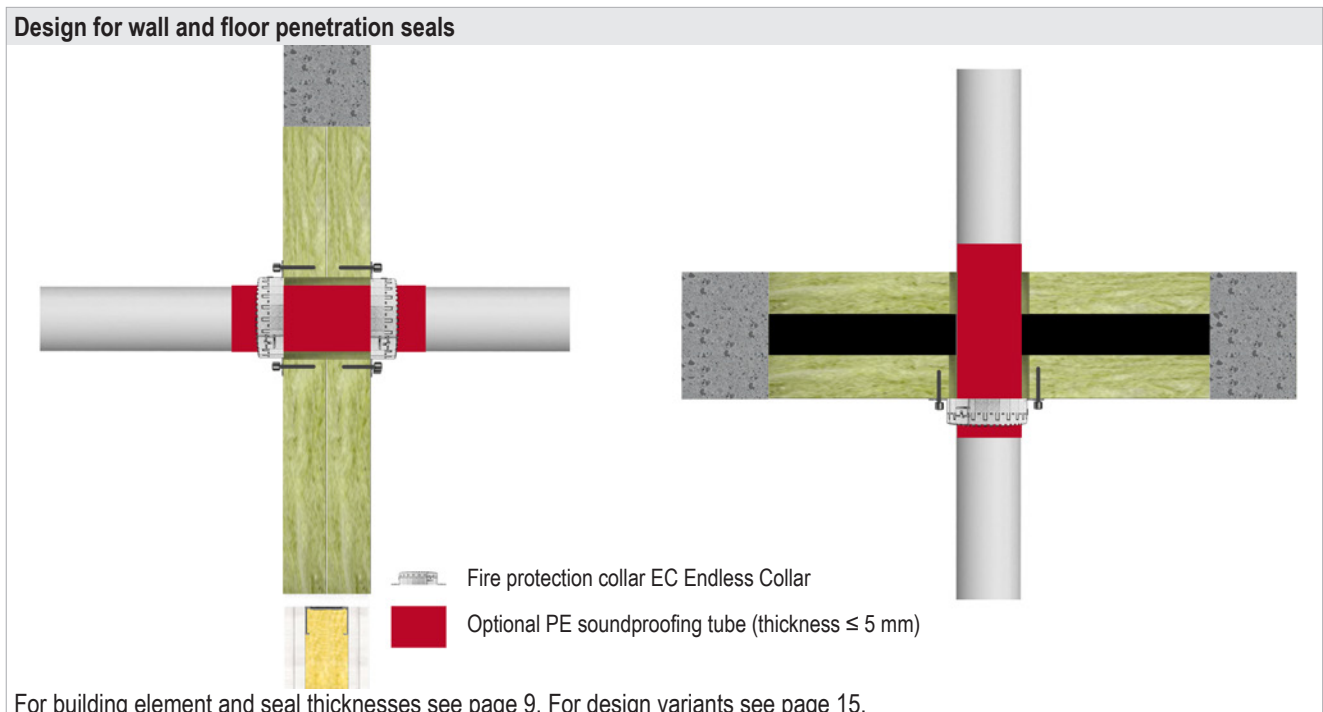

Pipe material	Pipe outer Ø [mm]	Pipe wall thickness [mm]	EC Endless Collar	Fire resistance class	
				Wall	Floor
PVC-U, PVC-C	40.0–50.0	1.8–5.6	on both sides in walls, on the lower side in floors	–	EI 120 U/U*
		2.0–5.6		EI 90 U/U*	–
	63.0–75.0	1.9–7.0		EI 90 U/U*	–
		2.1–5.1		–	EI 120 U/U*
	90.0–110.0	1.8–9.0		EI 90 U/U*	–
		2.6–4.3		–	EI 120 U/U*
	125.0	2.3–9.8		EI 90 U/U*	–
		2.8–4.0		–	EI 120 U/U*
	140.0	3.0–3.6		–	EI 120 U/U*
	140.0–160.0	3.2–11.9		EI 90 U/U*	–
160.0	3.2	–	EI 120 U/U*		

* Fastened with coarse thread screws Würth ASSY D, HECO-TOPIX-plus or SPAX T-STAR plus.

** Fastened with coil spring fasteners Rockwool Conlit Screw or Bohl Fireprotect Screw.

System Flammotect 2 × 50 mm

Pipe material / type	Pipe outer Ø [mm]	Pipe wall thickness [mm]	EC Endless Collar	Fire resistance class	
				Wall	Floor
PE-HD, ABS, SAN+PVC	40.0–50.0	1.8–4.6	on both sides in walls, on the lower side in floors	EI 120 U/U*	–
		4.6		–	EI 90 U/U*
	63.0–75.0	2.2–3.8		EI 90 U/U*	–
		3.8		–	EI 90 U/U*
	90.0	2.4–3.3		EI 90 U/U*	–
		2.7–3.4		–	EI 90 U/U*
110.0	2.7	EI 90 U/U*		EI 90 U/U*	
PP	40.0–50.0	1.8–4.6		–	EI 120 U/U*
	63.0–75.0	2.2–6.8		–	EI 90 U/U*
		63.0		3.8–6.8	–
	75.0	5.2–6.8		–	EI 120 U/U*
	90.0–110.0	2.7		EI 120 U/U*	–
		2.7–10.0	–	EI 90 U/U*	
	90.0	7.3–10.0	–	EI 120 U/U*	
	110.0	10.0	–	EI 120 U/U*	
POLO-KAL NG / POLO-KAL XS	90.0	3.0	EI 90 U/U*	–	
	110.0	3.4	EI 120 U/U**	–	
			EI 90 U/U*	–	
			EI 120 U/U**	–	
125.0	3.9	EI 120 U/U**	–		
160.0	4.9	EI 120 U/U**	–		
REHAU RAUPIANO PLUS	75.0	1.9	EI 90 U/U*	EI 120 U/U*	
	90.0	2.2	EI 90 U/U*	EI 120 U/U*	
			EI 120 U/U**	–	
	110.0	2.7	EI 120 U/U**	–	
	125.0	3.1	EI 120 U/U**	–	
160.0	3.9	EI 120 U/U**	–		
Geberit Silent-PP	32.0	2.0	EI 120 U/U**	EI 90 U/U*, **	
	50.0	2.0	EI 120 U/U**	EI 90 U/U*, **	
	75.0	2.6	EI 120 U/U**	–	
	90.0	3.1	EI 90 U/U*	–	
			EI 120 U/U**	–	
110.0	3.6	EI 90 U/U*	–		
			EI 120 U/U**	–	

* Fastened with coarse thread screws Würth ASSY D, HECO-TOPIX-plus or SPAX T-STAR plus.

** Fastened with coil spring fasteners Rockwool Conlit Screw or Bohl Fireprotect Screw.

System Flammotect 2 × 50 mm

Pipe material / type	Pipe outer Ø [mm]	Pipe wall thickness [mm]	EC Endless Collar	Fire resistance class	
				Wall	Floor
Wavin SiTech+	32.0	2.0	on both sides in walls, on the lower side in floors	EI 90 U/U*	EI 90 U/U*
				EI 120 U/U**	EI 90 U/U**
	50.0	2.1		EI 90 U/U*	EI 90 U/U*
				EI 120 U/U**	EI 90 U/U**
	75.0	2.6		EI 90 U/U*	–
	90.0	3.1		EI 90 U/U*	–
110.0	3.6	EI 90 U/U*	–		

* Fastened with coarse thread screws Würth ASSY D, HECO-TOPIX-plus or SPAX T-STAR plus.

** Fastened with coil spring fasteners Rockwool Conlit Screw or Bohl Fireprotect Screw.